



Lamp Ring

PROJECT PLANS

Finished Dimensions: 5-1/2"W x 5-1/2"H x 2-1/4"D

Skill Level: Beginner

Materials

Item	Qty
1/2"x 24"x 48" Sanded Plywood*	1
Electric Tealight	1
Wood Glue	
Sandpaper* *: 150g, 220g & 320g	
Drill Bits: 1/4"	
Hole Saws: 1-5/8" & 3-1/2"	

* Board Dimensions are "nominal". Actual dimensions are smaller due to lumber industry standards. Cuts are actual length.

** Starting grit will depend on board surface condition, a rough surface will require starting with a coarse grit first.

Grit is measured in the coarseness of the particles on the sandpaper. The lower the grit number, the coarser the paper. Heavy sanding would require 60 to 80 grit, medium sanding would require 120 to 220 grit, and finish sanding would require 320 to 400 grit. Super fine sanding would be 600 grit and higher.

A select/premium board or plywood comes with a smoother surface finish. It is clear or has very few tight knots, and it will have straight and sharp edges. This grade of wood pairs well with other boards or panels better and requires less time to sand and finish.

Tools Used



10" Sliding Miter Saw



Circular Saw



1/2" Hammer-
Drill/Driver



5" Random Orbit
Sander



Router Trim



Tape Measure



Drill Bits



Roundover Router
Bit Set



5" Orbit Sandpaper



1-5/8" Hole Saw



3-1/2" Hole Saw

Also Needed: Safety Glasses, Speed Square and Clamps

Lumber Cut List

Board*	Description	Cut to	Qty
3/4" x 5-1/2"	Ring Squares	5-1/2"	3

*Board Dimensions are "nominal". Actual dimensions are smaller due to lumber industry standards. Cuts are actual length.

Lumber & Sheet Layout Guide

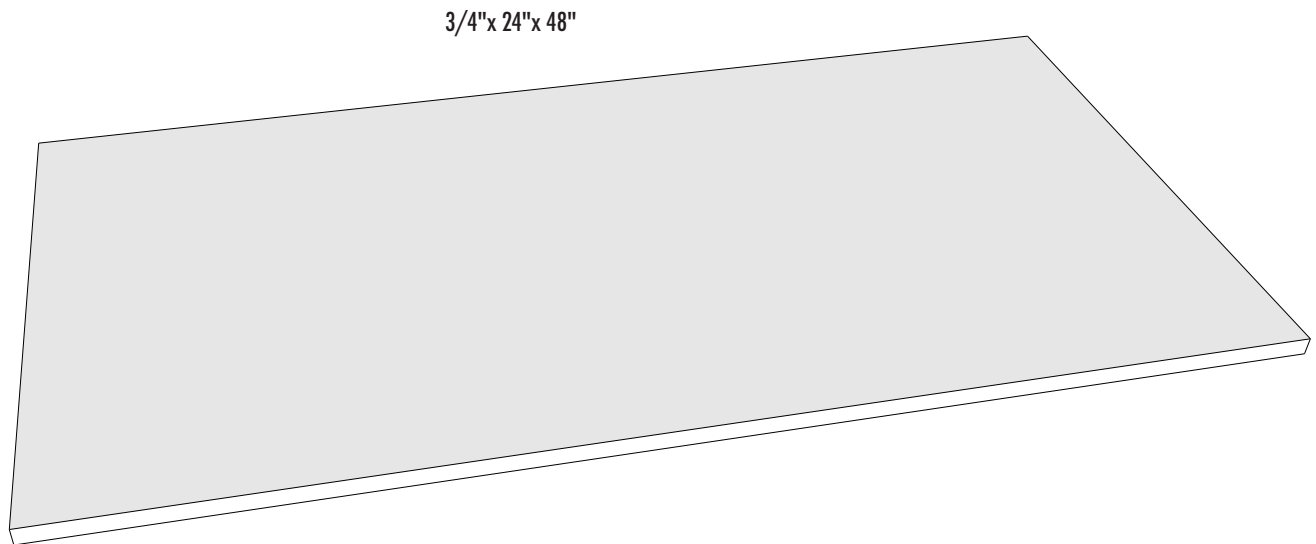

Assembly Instructions

Step 1



Cut a strip off the plywood sheet at 5-1/2".

Some initial sanding can be done after cutting the boards and panels. Sanding pieces prior to building can make the process easier before final assembly. Refer to last page for sanding information.

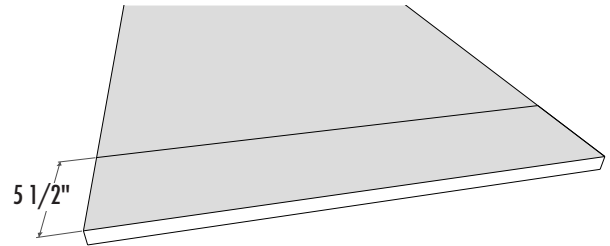

Step 2



Mark wood strip at 5-1/2" and cut using Miter Saw

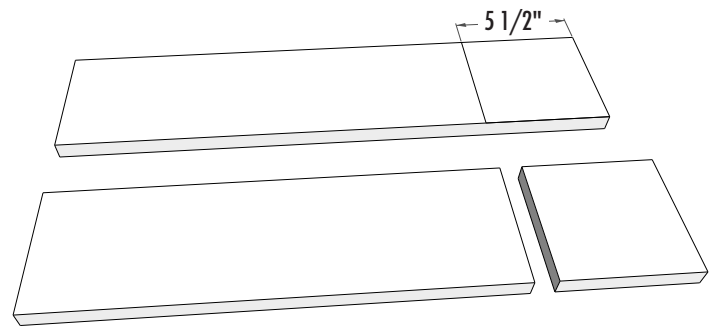

Step 3



Mark again and cut another 5-1/2" square.

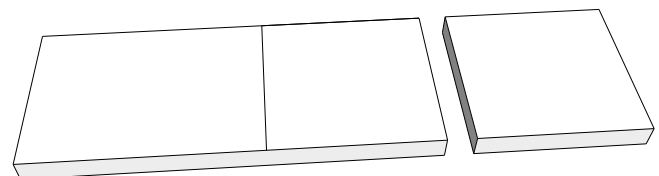

Step 4

Align three sides, glue and clamp together.

Let glue dry per glue recommendations.

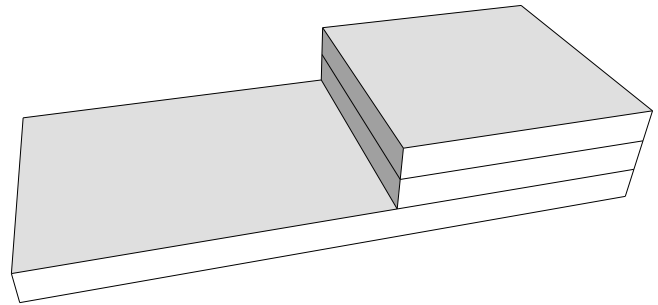

Step 5



Align Miter Saw blade to edge of 5-1/2" square blocks and clamp.

Cut base board.

Sand all sides and make flush.

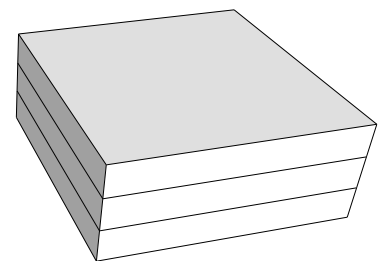
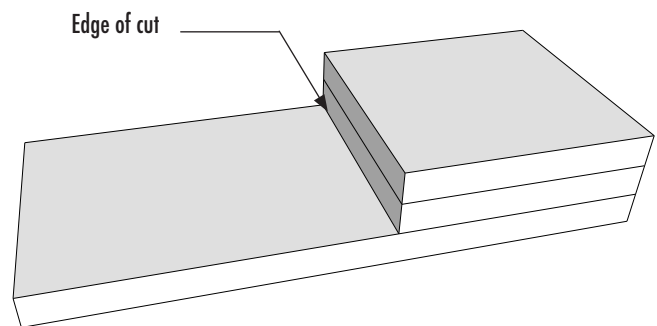

Step 6

Draw lines across block face and bottom edge to find centers. This is for holes saw drill points.

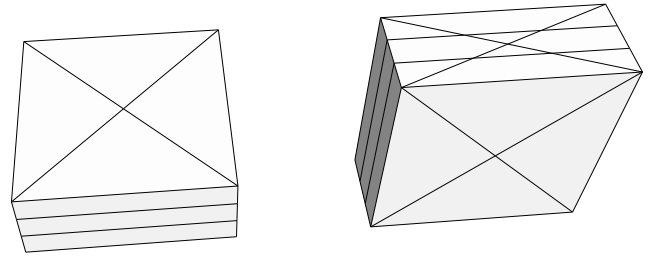

Step 7



Use a 1-1/2" hole saw, drill down and bottom-out saw into bottom of block.

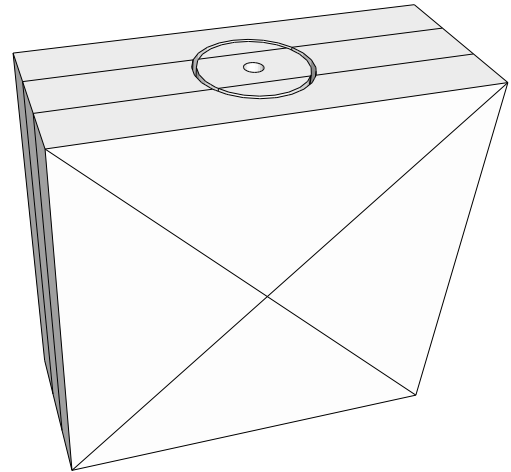

Step 8



Use a 3-1/2" hole saw, drill down about two-thirds the way through block.

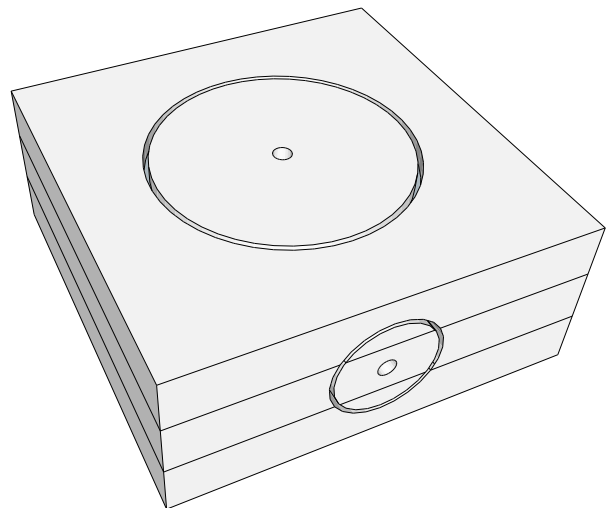

Step 9



Using a 1/4" drill bit continue drilling through 3-1/2" pilot hole until through block.

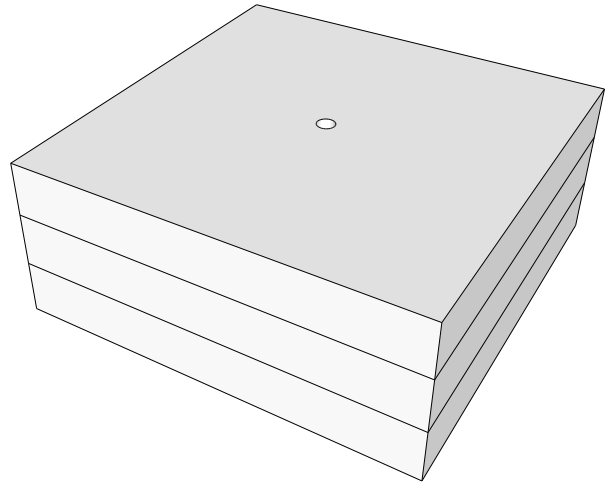

Step 10



Using this 1/4" hole continue drilling down with 3-1/2" hole saw until contacted with reverse hole saw cut.

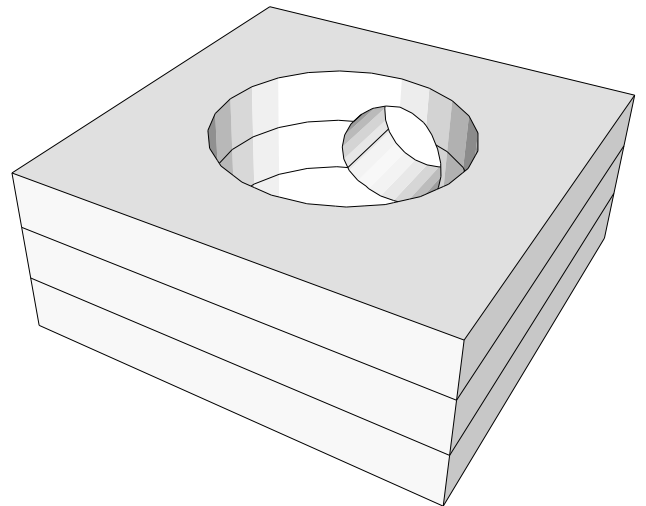

Step 11



With the 1/2" Roundover Bit, route the radius of the four corners.

Sand and finish to your desire.

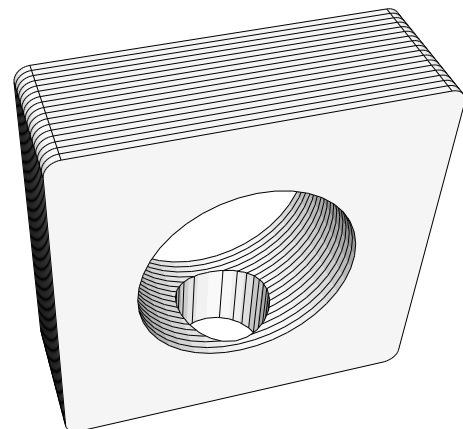

Step 12

Add electric tealight to bottom hole.

Project complete!

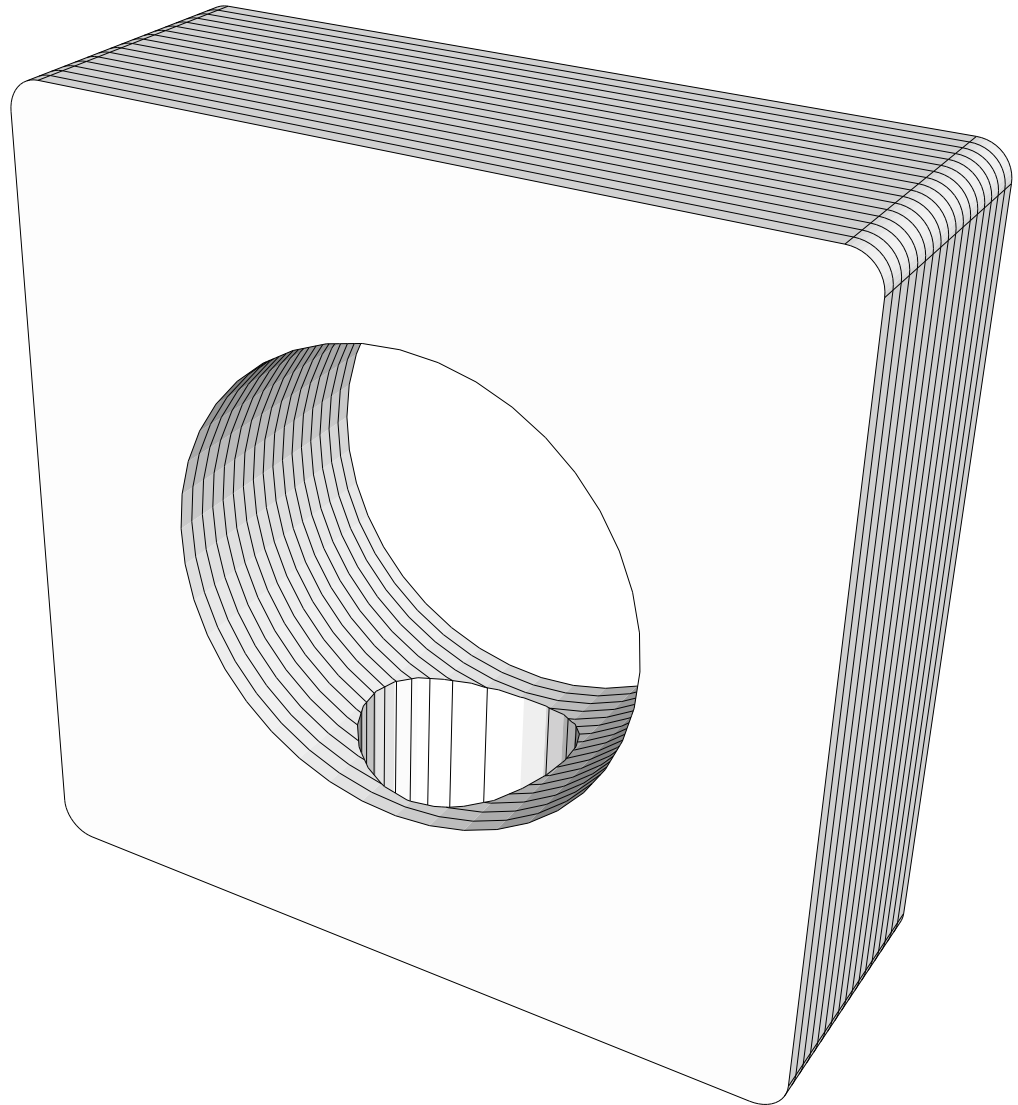

Rougher finish – Use 60-80 grit sandpaper to hand sand with the grain of the wood.

Smoother finish – Use 60-80 grit sandpaper to remove scratches & imperfections. Followed by using 120-220 grit to smooth.

Finish Sanding – Use 320-400 grit sandpaper

Super fine sanding – Use 600+ grit sandpaper

