



Charcuterie Board

PROJECT PLANS

Finished Dimensions: 5-1/2"W x 1-1/2"H x 21-3/4"D

Skill Level: Beginner

Materials

Item	Qty
2" x 6"x 36" Board *	1
1" x 6"x 12" Board *	1
5/8"D,9/16"CL,1/4"SH Top Bearing Route Bit	1
Sandpaper* *: 150g, 220g & 320g	
Drill Bits: 3/8"	
3-1/4" Hole Saw	

* Board Dimensions are "nominal". Actual dimensions are smaller due to lumber industry standards. Cuts are actual length.

* * Starting grit will depend on board surface condition, a rough surface will require starting with a coarse grit first.

Grit is measured in the coarseness of the particles on the sandpaper. The lower the grit number, the coarser the paper. Heavy sanding would require 60 to 80 grit, medium sanding would require 120 to 220 grit, and finish sanding would require 320 to 400 grit. Super fine sanding would be 600 grit and higher.

A select/premium board or plywood comes with a smoother surface finish. It is clear or has very few tight knots, and it will have straight and sharp edges. This grade of wood pairs well with other boards or panels better and requires less time to sand and finish.

Tools Used



7-1/4" Sliding
Compound Miter Saw

or



Circular Saw



Jig Saw



1/2" Hammer-
Drill/Driver



Router Trim



5" Random Orbit
Sander



Tape Measure



Drill Bits



3-1/4" Hole Saw



5" Orbit Sandpaper



Roundover Router
Bit Set

Also Needed: Safety Glasses, Speed Square and Clamps

Lumber Cut List

Board*	Description	Cut to	Qty
2" x 6"	Charcuterie Board	36"	1
1" x 6"	Template Board	12"	1

*Board Dimensions are "nominal". Actual dimensions are smaller due to lumber industry standards. Cuts are actual length.

Lumber & Sheet Layout Guide

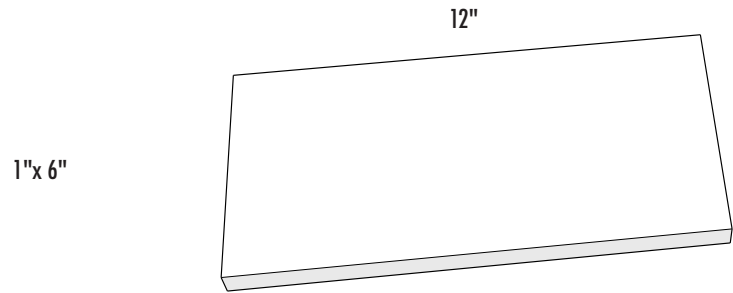
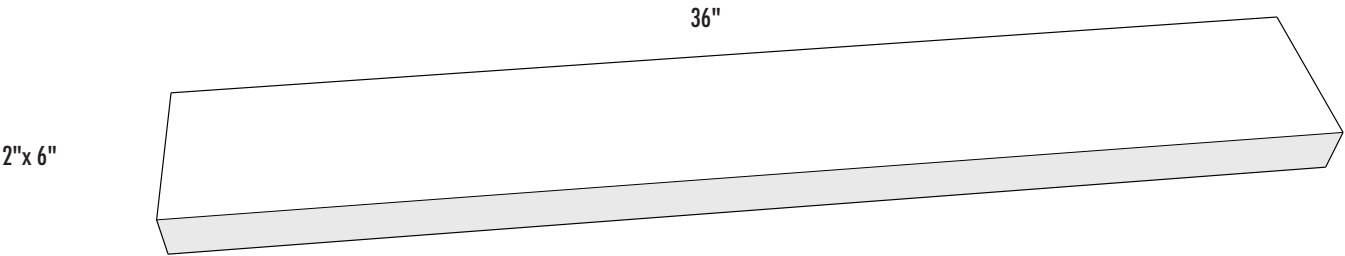

Assembly Instructions

Step 1



On the 1"x6"x12" Template Board draw a straight line down the middle. Then find center of that line.

At that center point cut a 3-1/4" hole using Hole saw and Driver.

Sand as needed to make smooth.

Mark inside of cut hole the center line.

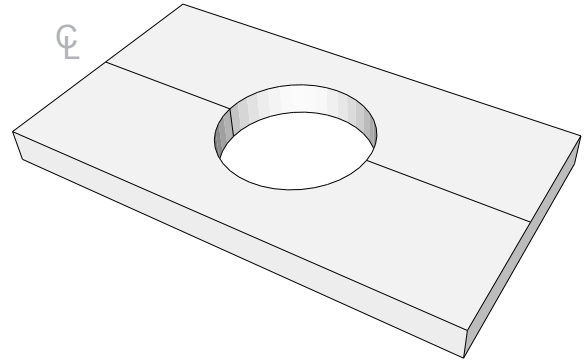

Step 2



Draw a straight line down center of 2"x 6" board. Then measure 2" from end and mark.

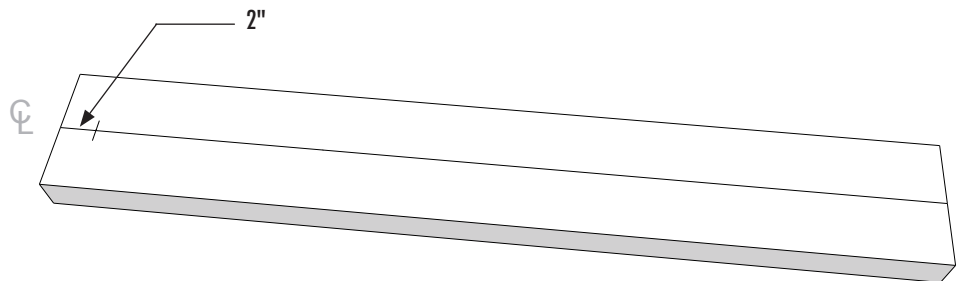

Step 3

Align center lines on template board with center line on 2"x 6" board, then slide edge of circle to meet 2" mark.

Clamp template board to 2"x 6" board and then board to table.

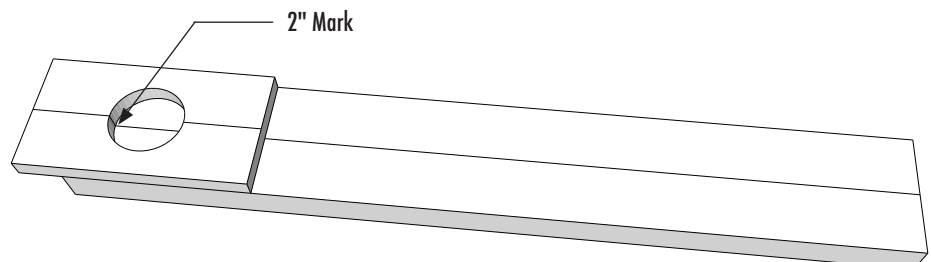

Step 4



Using Top Bearing Bit and Trim Router cut 1/4" recess into board.

Cut 1/8" at a time. To plunge bit into wood set one edge of router base on template with bit inside of hole. Slowly rotate router until sitting flat on base.

Work from the inside of hole outwards until router bit bearing is riding on edge of template hole. Run around until smooth.

From edge of hole measure 2-1/2" and mark.

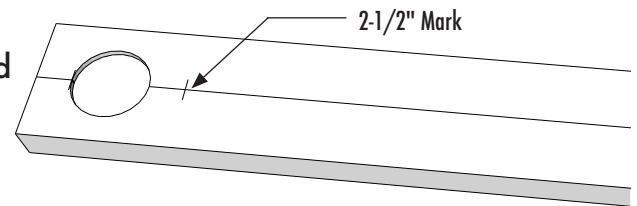
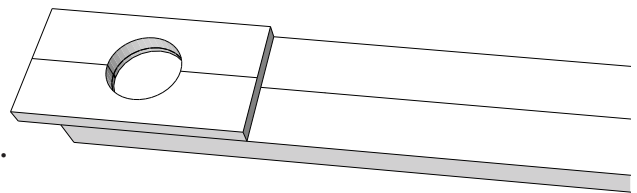

Step 5



Repeat steps 3 & 4 to rout out second recess.

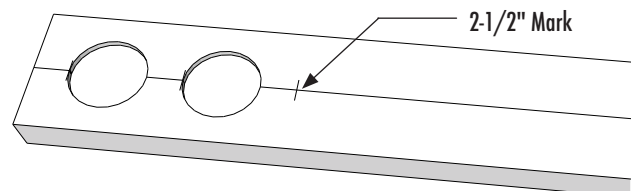
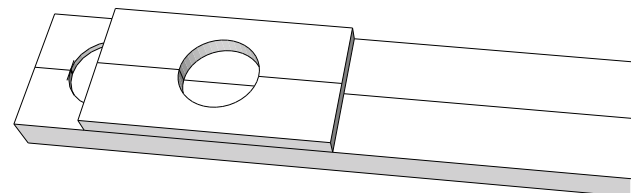

Step 6



Repeat again to rout out third recess.

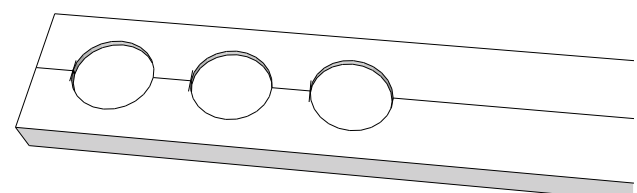
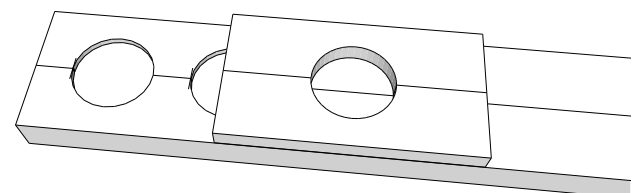

Step 7



Mark a radius on both sides of one end.

From edge of third hole measure and mark at 5". Draw a 3" handle 1-1/2" thick and add radius's to match opposite end.

Cut along lines with Jig Saw to create shape of Charcuterie Board.

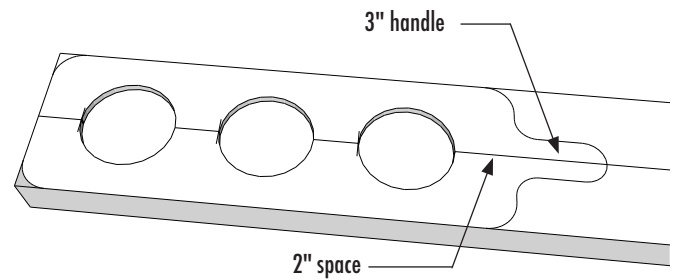

Step 8



Drill a 3/8" hole though center radius of handle.

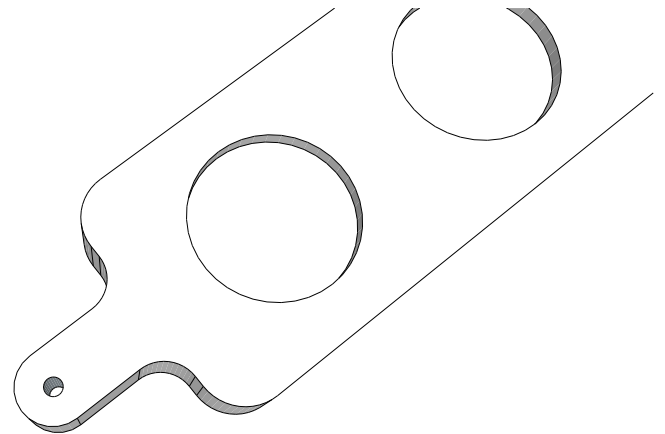

Step 9



Router outside edges with Roundover Bit.

Sand and finish to your desire.

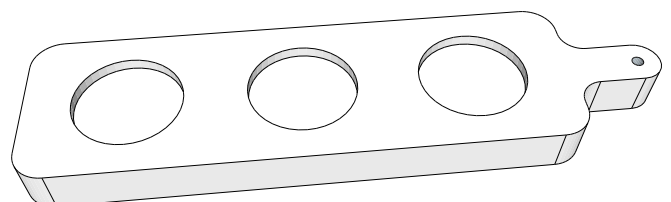

Step 10

Project complete!

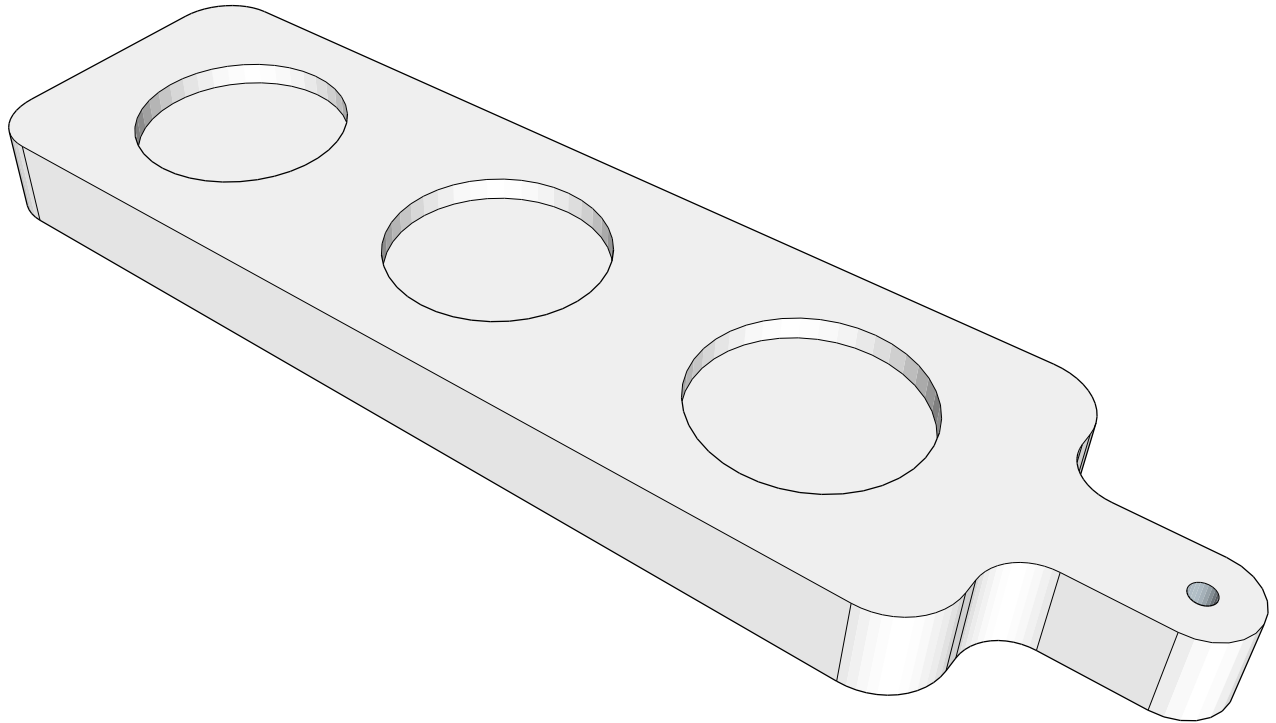

Rougher finish – Use 60-80 grit sandpaper to hand sand with the grain of the wood.

Smoother finish – Use 60-80 grit sandpaper to remove scratches & imperfections. Followed by using 120-220 grit to smooth.

Finish Sanding – Use 320-400 grit sandpaper

Super fine sanding – Use 600+ grit sandpaper

